



PRODUCT DATA SHEET

Coaxial Cable Connect: DIN-F7/8

Description

DIN(F) Connector for 7/8" Cable

Suitable standard

IEC 60169-4

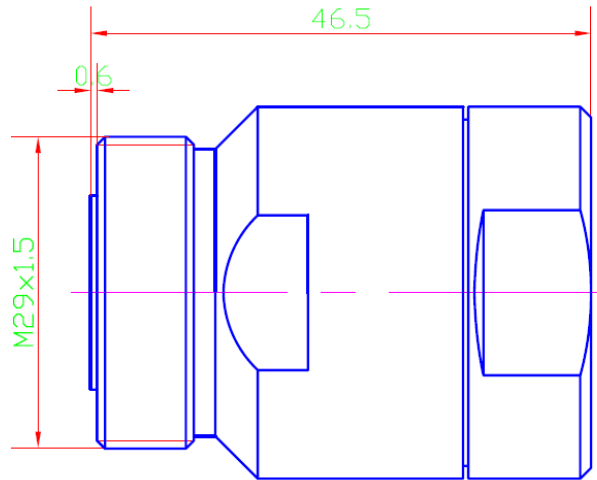

MATERIALS & PLATING

	Description	Material	Surface Plating	Remark
1	Shell/Body	BRASS	Nickel or Tri-Allory	
2	Center Conductor	Phosphor branze	Gold or Silver	
3	Insulator	PTFE		

ELECTRICAL CHARACTERISTICS

	Item	Technical Data
1	Impedance	50Ω
2	Frequency range max	DC-3.5GHz
3	Contact Resistance	Center conductor ≤ 0.4mΩ, Outer conductor ≤ 1mΩ
4	Insulation Resistance	≥ 10000MΩ
5	VSWR	DC~3.5GHz<1.1

MECHANICAL CHARACTERISTICS

1	Durability	≥ 500 cycles
---	------------	--------------

ENVIRONMENTAL CHARACTERISTICS

1	Temperature range	Cable: - 40°C to +85 °C
---	-------------------	-------------------------